



MEDIA ADVISORY

October 8, 2015

Contact: Heather Geyer, Administrative Services Director/PIO

hgeyer@ci.wheatridge.co.us / 303-235-2826

Traffic Alert on 32nd Ave. between Wadsworth Blvd. and Kipling

Saturday & Sunday, October 10 & 11 from 7 am - 5 pm

WHAT: Asphalt paving operations will occur on 32nd Ave. between Wadsworth Blvd. and Kipling St. on Saturday & Sunday, October 10 & 11 from 7 am - 5 pm. W. 32nd Ave. will be closed to all thru-traffic, motorists will need to take alternate routes. Please follow detour signs or choose an alternate route.

WHEN: Saturday, October 10th & Sunday, October 11th

TIME: 7 a.m. to 5 p.m.

WHERE: 32nd Ave. between Wadsworth Blvd. and Kipling St.

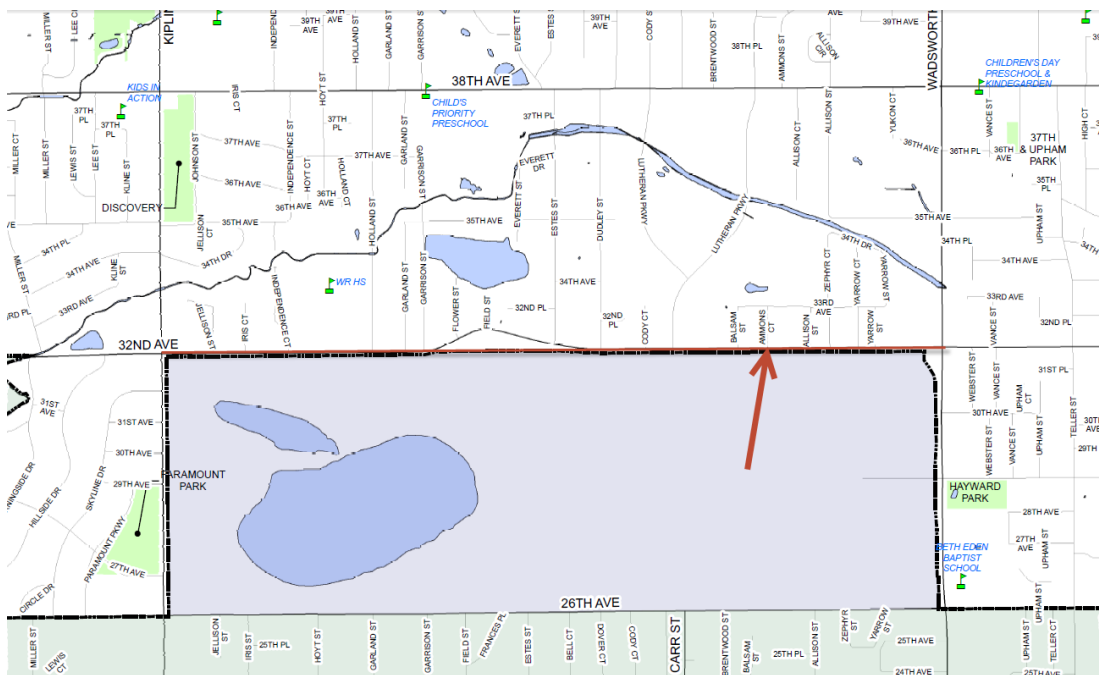

###